



Finger pass SF-2500

SF-2500 is a state of the art access control system with the highest performance in fingerprint recognition, access control management, and efficient T&A (Time and Attendance).



One of the world's fastest fingerprint readers



Built in 2.5 inch graphic LCD screen



Any Direction Fingerprint Recognition



Supports SD memory card



Wiegand Protocol



Extension Phone Function



- Features**
- The 2.5" LCD screen displays system information
 - Selective access control is configurable
 - Interface is possible for a number of access control system via the wiegand protocol



Finger pass SF-2500



System Layout

- Safe, secure, and economical access control system
- Any new installations can be integrated into existing access control systems
- Securing facilities, reducing costs via time management

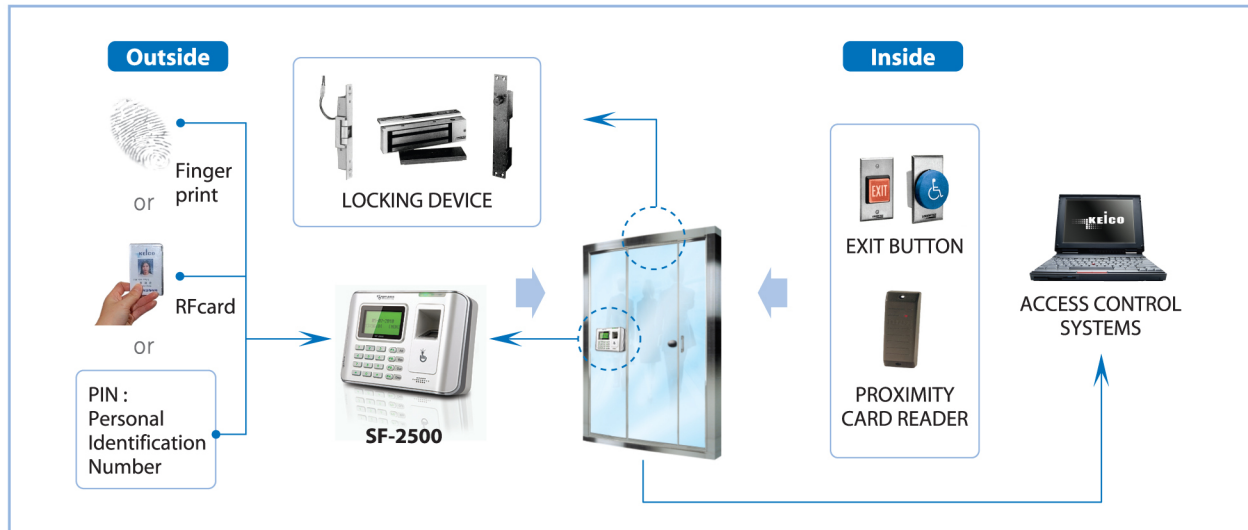

Features



One of the world's fastest fingerprint readers

2,000 fingerprints read & recognition in 0.3 seconds Can save up to 60,000 events



Built in 2.5 inch graphic LCD screen

Displays detailed information such as date, time, user guide, and user list, etc.



AUTO & Direction Fingerprint Recognition

Can read fingerprints placed in any direction



Supports SD memory card

Can easily upload & download records of fingerprint data, events time and attendance with a SD memory card



Wiegand Protocol

Compatible with other access controller systems using the Wiegand Protocol



Extension Phone Function

Built-in MIC speaker for internal communication



Configurable Access control

The ability to set a specific date (date & time zones) to control access effectively



RF Card

125KHz and 13.56MHz (HID Proximity and iCLASS)



Specifications

CPU	32bit CPU
Display	2.5" B/W Graphic LCD
RF reader	125KHz / 13.56MHz (HID / Mifare / EM)
Communication type	TCP/IP, RS-485
External Interface	Wiegand, Micro SD Memory Card
User Registration	2,000 User's Fingerprints
Event log	Maximum 60,000 events
Operation Mode	Password/Fingerprint/card mixture
Inputs & Outputs	8 In / 4 Out
Power	12V DC 500mA
Produce size	116(H) x 175(W) x 59(D)mm
Other	Firmware upgrade available
	Error search function available
	CE, FCC certified